

- [C] NOTES:
1. RATINGS
 - a. CURRENT RATING: 1 AMP
 - b. VOLTAGE RATING: DC 12 V.
 2. ELECTRICAL
 - a. CONTACT RESISTANCE: $\leq 20m\ \Omega$ MAX.
 - b. INSULATION RESISTANCE: $\geq 100\ M\Omega$
 - c. DIELECTRIC WITHSTANDING VOLTAGE: AC 500V MAX.
 3. RESISTANCE TO SOLDERING HEAT: $235^{\circ}\ C \pm 5^{\circ}\ C$ FOR 3 SECONDS
 4. THE UNSPECIFIED TOLERANCE IS:
 - $< 6 \pm 0.2$
 - $6 \sim 20 \pm 0.3$
 - $> 20 \pm 0.4$

ORDERING INFORMATION
PJ1412 - X

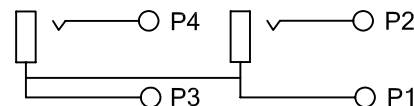

CIRCUIT DIAGRAM

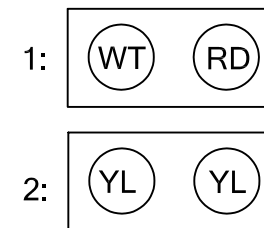

COLOR LAYOUT

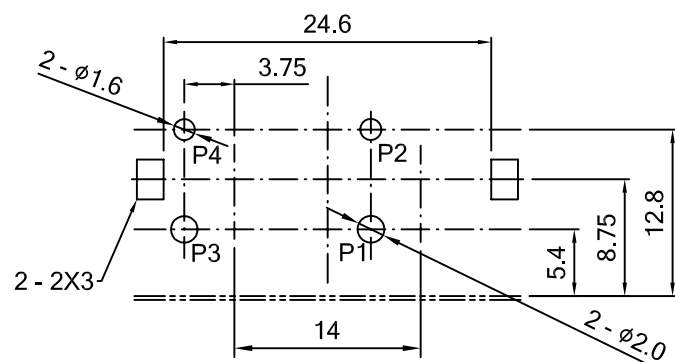

RECOMMENDED PCB LAYOUT
<TOP VIEW>

NOTE: TOLERANCE FOR PCB LAYOUT IS ± 0.05

NO.	NAME	QTY	MATERIAL	NOTES
6	SHIELD PATCH	1	H62 BRASS $t=0.25$	CuSn
5	PINCER NEEDLE	2	H62 BRASS $t=0.4$	CuSn
4	WASHER	2	PBT	_____
3	OUTER CONDUCTOR	1	H65 BRASS $t=0.36$	CuSn
2	COVER	1	ABS, 94HB, BLACK	_____
1	BASE	2	ABS, 94V-0, WHITE	_____

TOLERANCE	
LINEAR	ANGLES
X. \pm	X° \pm
.X \pm	.X° \pm
.XX \pm	.XX° \pm
.XXX \pm	.XXX° \pm

GENESIS
TECHNOLOGY, INC. 1015 GRANT STREET S.E.
ATLANTA, GA 30315
a Genesis Electro-Mechanical Company

TITLE:					
1 x 2 PORTS RCA PIN JACK					
PART NO.	PJ1412 - X				
DWG NO.	SC-10621				
UNITS	SCALE	SHEET	REV		
MM	NONE	1 OF 1	C		

REV	ECN NO.	NAME	DATE	.XXX \pm	.XXX° \pm
[C]	UPDATED DRAWING ADDED NOTES	FOX	8/19/11'	X. \pm	X° \pm
[B]	ADD RoHS COMPLIANT	AXL	3/12/08'	.X \pm	.X° \pm
[A]	ISSUED	AXL	1/23/07'	.XX \pm	.XX° \pm